

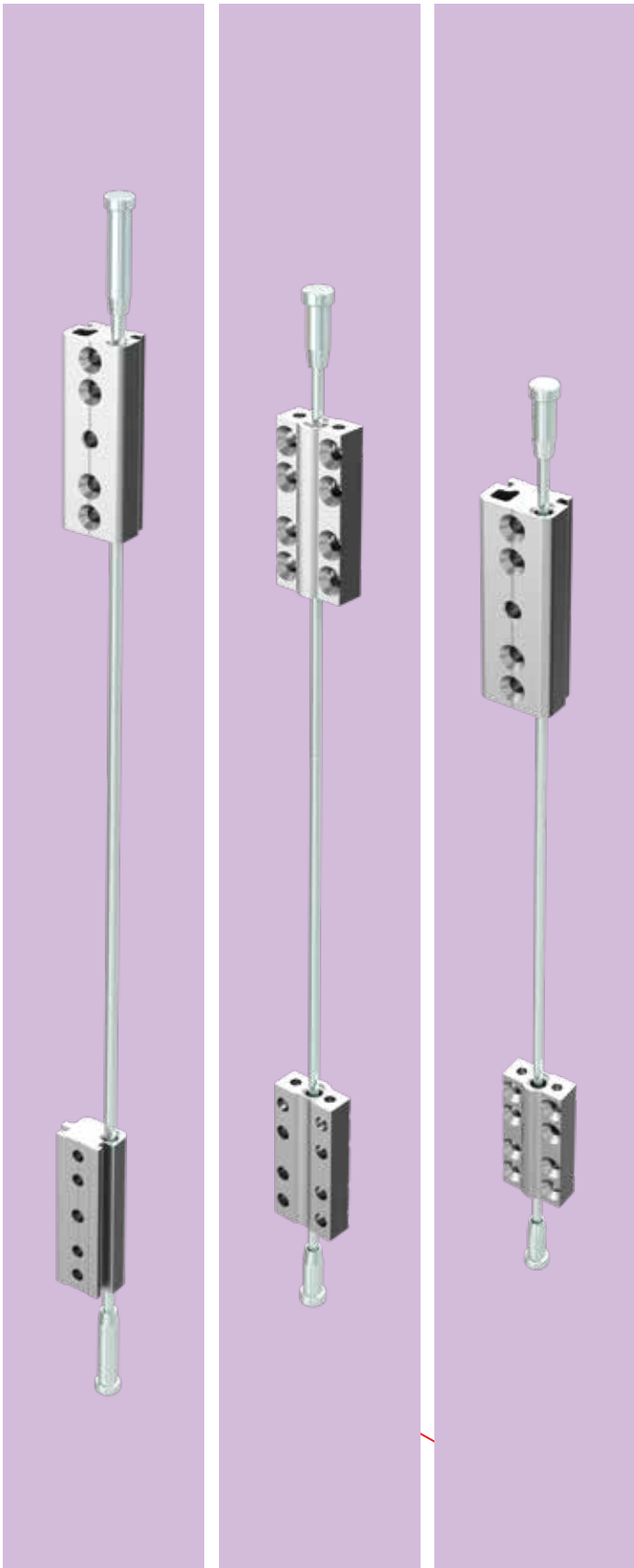

Fall Arrestors



Range

1. Euro Groove / Euro Groove (EG/EG)
2. Euro Groove / Non-Euro Groove (EG/NEG)
3. Non-Euro Groove / Non-Euro Groove (NEG/NEG)

Fall Arrestors

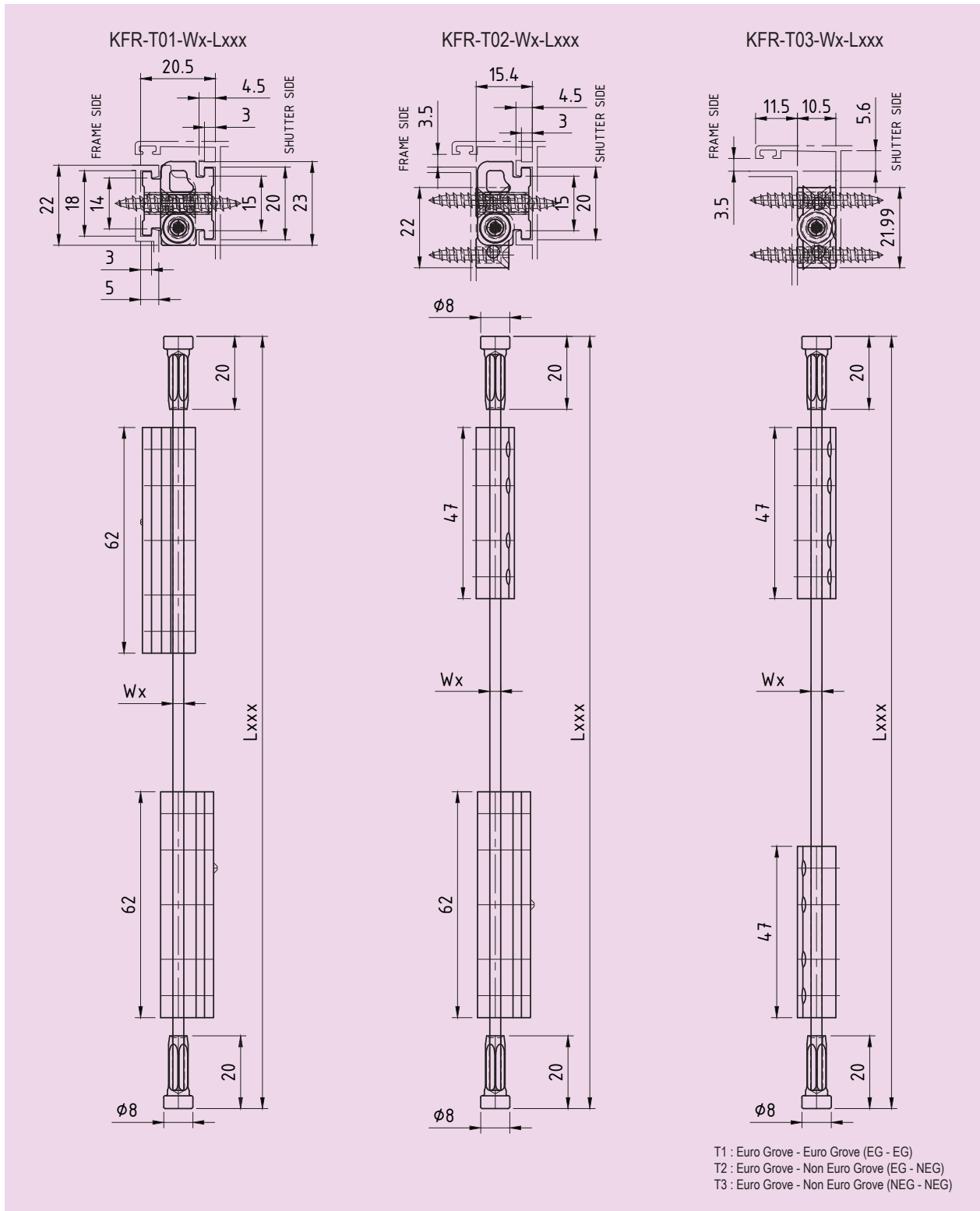

LOAD RATING DETAILS

#	Art. Code	Grove Type	Wire Dia. Wx (mm)	Static Load (kgf)	Max. Vent weight (Kgs)
1	KFR-T01-W3-L435	EG - EG	3	450	90
2	KFR-T02-W3-L435	EG - NEG	3	450	90
3	KFR-T03-W3-L435	NEG - NEG	3	450	90
4	KFR-T01-W4-L535	EG - EG	4	815	160

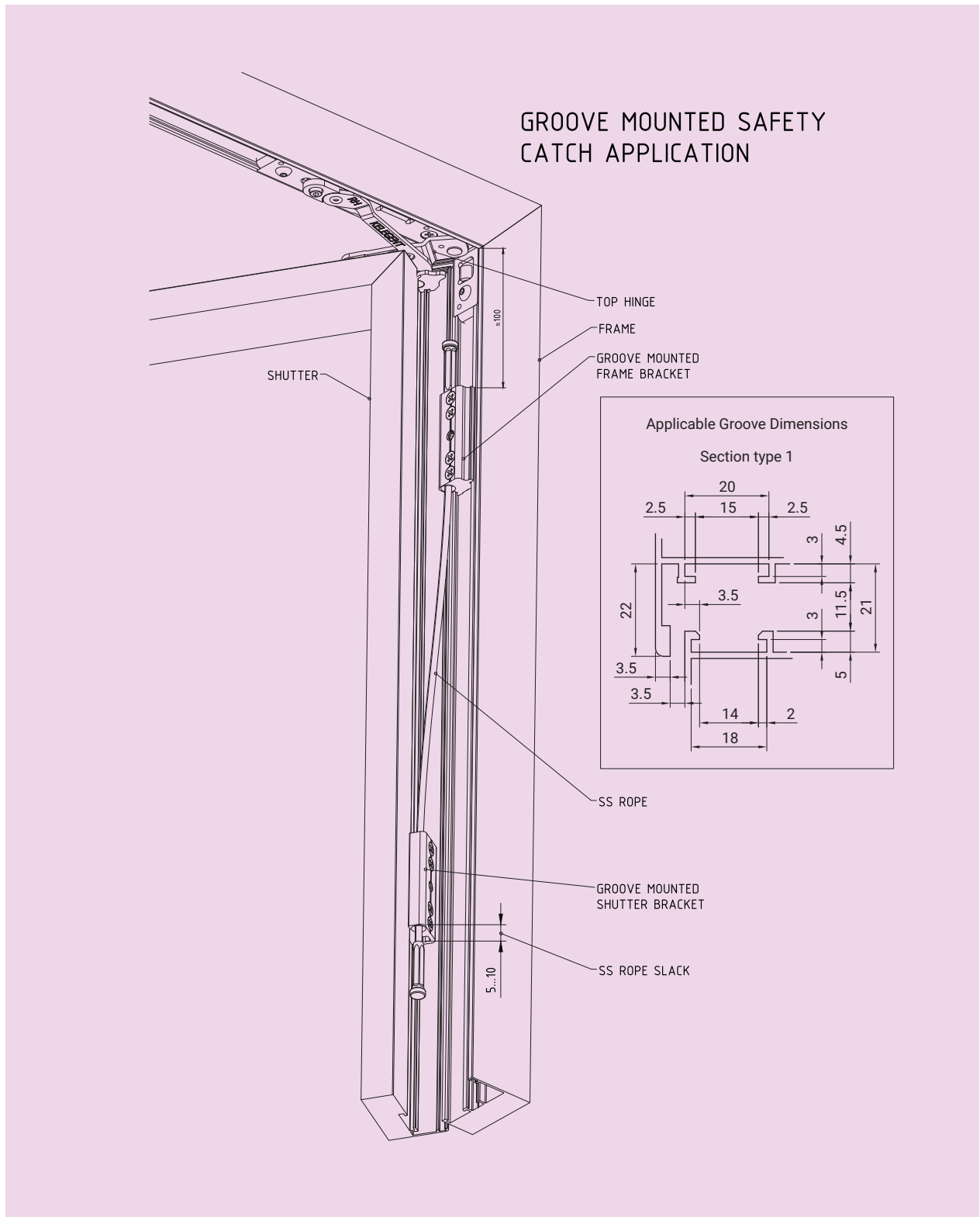

Fall Arrestors

Technical Application

KFR-T02-WX-LXXX

